

Underlay fitting guidelines



A Ensure that the subfloor is reasonably level, sound, dry and free from dust, grease or other contaminants.

Timber Floors: Nail loose floorboards down and hammer all protruding nails flush.

Concrete: Fill any deep gaps and sand all protruding lumps down.

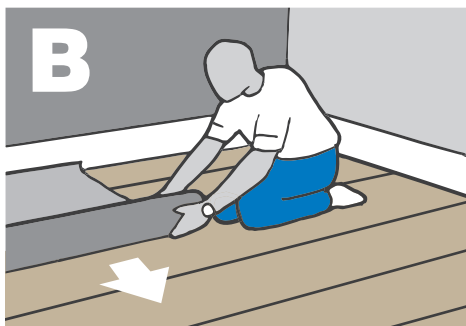

B Whisper underlay can be laid either side up but must be laid at right angles to any existing floorboards. When installing **Whisper** underlay allow for a 5cm excess to run up the walls.

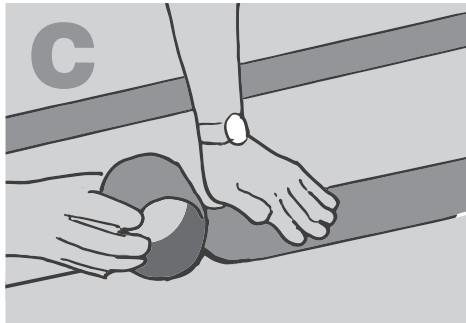

C All edges of the **Whisper** underlay should be closely butted up against the adjoining roll and the overlap securely taped using a single-sided waterproof tape. This should then form a moisture-resistant sub-floor ready for the desired flooring to be fitted.

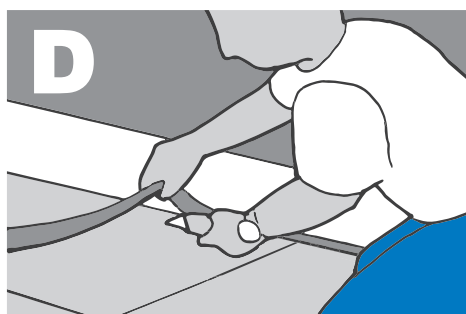

D Once the laminate or wood flooring has been laid, the 5cm excess **Whisper** underlay around the perimeter can then be trimmed flush with the flooring. The perimeter of the room can then be finished with skirting, scotia, etc.

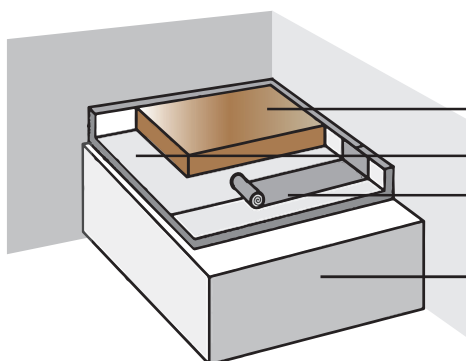

Wood/Laminate
Whisper underlay
 Single sided waterproof tape
 Sub floor

it's time to get wise

about **flooring installation** with our other **market-leading** products:

When it comes to flooring installation, **Floorwise** is the name for **quality** and **value!**

For **over 40 years** Floorwise has been the **number one choice** for flooring professionals.

Reliable service, through an exclusive network of distributors, and the consistent quality of our products has earned Floorwise an enviable reputation. Floorwise strives to deliver excellence in innovation too, with a continuous development programme aimed at meeting the evolving needs of both consumers and installers alike.



find us on @floorwisehq or visit us at www.floorwise.co.uk

© Floorwise Group Ltd, 2023

